

 <b>KTR</b> Kupplungstechnik GmbH D-48407 Rheine	<b>CLAMPEX® KTR 105</b> <b>mounting instructions</b>		KTR-N 40827 E
			sheet: 1
			edition: 1

The **CLAMPEX®** clamping set is a frictionally engaged, detachable shaft - hub connection for cylindrical shafts and bores without feather key.

### General Hints

Please read through these mounting instructions carefully before assembling the clamping set. Please pay special attention to the safety instructions!  
The mounting instructions are part of your product. Please keep them carefully and close to the clamping set.  
The copyright for these mounting instructions remains with **KTR Kupplungstechnik GmbH**.

### Safety and Advice Hints



**DANGER !** Danger of injury to persons.



**CAUTION !** Damages on the machine possible.



**ATTENTION !** Pointing to important items.

### General Hints to Danger



**DANGER !** With assembly and disassembly of the clamping set it has to be made sure that the entire drive train is protected against unintentional engagement. You can be seriously hurt by rotating parts. Please make absolutely sure to read through and observe the following safety instructions.

- All operations on and with the clamping set have to be performed taking into account "safety first".
- Please make sure to disengage the power pack before you perform your work at the clamping set.
- Protect the power pack against unintentional engagement, e. g. by providing hints at the place of engagement or removing the fuse for current supply.
- Do not touch the operation area of the machine as long as it is in operation.
- Please protect the rotating drive parts against unintentional touch. Please provide for the necessary protection devices and caps.

### Proper Use

You may only assemble and disassemble the clamping set if you

- have carefully read through the mounting instructions and understood them
- and if you are authorized and have proper skills

The clamping set may only be used in accordance with the technical data (see **CLAMPEX®** catalogue). Unauthorized modifications on the clamping set are not admissible. We do not take any warranty for resulting damages. To further develop the product we reserve the right for technical modifications. The **CLAMPEX®** clamping set described in here corresponds to the technical status at the time of printing of these mounting instructions.

Schutzvermerk ISO 16016 beachten.	Gezeichnet: 23.07.04 Sha/Hg	Ersatz für:
	Geprüft: 23.07.04 Sha	Ersetzt durch:



The clamping set is generally delivered in assembled condition.

**Tolerances, surfaces**

A good rotating process is sufficient:  
**Rz ≤ 16µm**

Highest permissible tolerance:  
**d = h9/H9 - shaft/hub**

**Components of CLAMPEX® KTR 105**

component	quantity	designation
1	1	external ring (slotted)
2	1	internal ring (slotted)
3	see catalogue	capscrews DIN 912

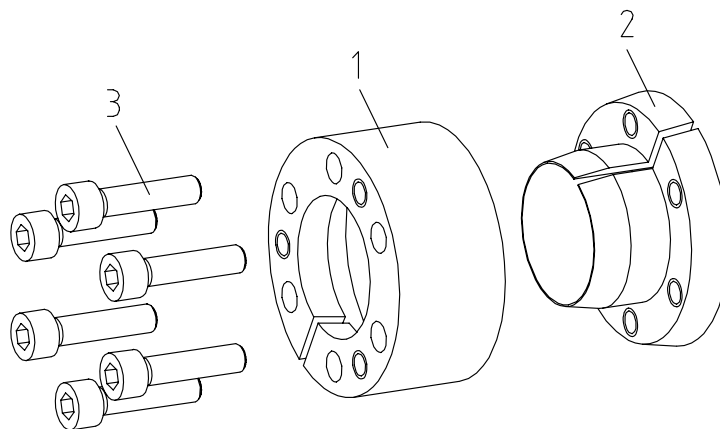

picture 1: CLAMPEX® KTR 105



**ATTENTION !**

**Dirty or used clamping sets must be disassembled, cleaned and afterwards oiled with thin-bodied oil (e. g. Castrol 4 in 1 or Klüber Quitsch Ex) before the assembly.**



**CAUTION !**

**When assembling the internal ring (part 2) and the external ring (part 1) please make sure that the slots are staggered. The forcing thread of the internal ring (part 2) must not be congruent with the slot of the external ring (part 1).**

**Assembly**

- Check the position of shaft and hub regarding the stipulated tolerance (h9/H9).
- Clean the hub bore and the shaft and afterwards oil them with thin-bodied oil (e. g. Castrol 4 in 1 or Klüber Quitsch Ex).



**CAUTION !**

**Do not use oils and greases with molybdenum disulphide or high pressure additions as well as slide grease pastes.**

- Unscrew the clamping screws slightly and insert the clamping set KTR 105 between shaft and hub.
- Slightly tighten the clamping screws manually and align the clamping set with hub part.

Schutzvermerk ISO 16016 beachten.	Gezeichnet: 23.07.04 Sha/Hg	Ersatz für:
	Geprüft: 23.07.04 Sha	Ersetzt durch:



## Assembly

### Continuation:

- Tighten the clamping screws evenly and crosswise. Increase the tightening torque step by step. This procedure must be repeated until the tightening torque indicated in table 1 is reached with all clamping screws.

**Table 1:**

type of clamping set	105					
screw size M	M2,5	M3	M4	M5	M6	M8
tightening torque $T_A$ [Nm]	1,2	2,2	4,9	10	17	41



### ATTENTION !

During the assembly there can be a slight axial displacement of the hub opposite to the shaft in case of KTR 105.

## Disassembly



### DANGER !

Loosened or falling drive parts can cause injuries to persons or damages to the machines.

Safe the drive parts before the disassembly.

- Loose all clamping screws evenly one after the other and unscrew them.
- Screw the clamping screws into the threads of the internal ring (component 2).
- Tighten the clamping screws evenly and crosswise. Increase the tightening torque step by step until the external ring (component 1) and the internal ring (component 2) are separated.
- Remove the unscrewed clamping set between shaft and hub.

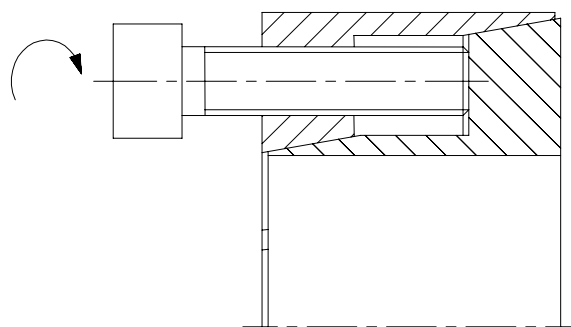

picture 2: unscrew the clamping set KTR 105



### CAUTION !

In case of non-observance of these hints or in case of non-considerance of the operating conditions regarding the selection of the clamping set, the function of the clamping set can be influenced.

### Disposal of waste:

*Defective clamping sets must be cleaned and scrapped.*

Schutzvermerk ISO 16016 beachten.	Gezeichnet: 23.07.04 Sha/Hg	Ersatz für:
	Geprüft: 23.07.04 Sha	Ersetzt durch: